

## TIPS FOR CORRECT USE

- At delivery, carry out optical check for functional capability
- The insulation slab must not be subjected to any mechanical loads during processing and application
- Avoid intermittent stress on the coating as well as prolonged shaking or pulling
- Make sure that the insulation slabs are subjected to an even, flat compressive load and that tensile and shear forces are avoided
- Ensure that trained specialists are on site for individual advice and execution
- Cleanly join and tape all longitudinal and transverse joints together



## BACHL INSULATION RANGE

Variety of products

The product range of Bachl offers optimal solutions for a perfectly high-quality insulation, optimized for an easy and appropriate processing.

- **EPS:** heat loss on steep roofs, flat roofs, walls, floors and ceilings is efficiently avoided.
- **BACHL XPS®:** XPS is an allrounder among insulating materials and can be used individually.
- **Styrodur®:** For more than 50 years, Styrodur® has been the sustainable solution for almost all building physics and practical building requirement and the first insulation material approved by the building authorities for earthquake regions.
- **PUR:** The high efficiency insulating material is used where little structure height and high insulating values are required.
- **PERLIT:** Perlit is economically friendly and totally inconsequential for health. Besides its properties as thermal and impact sound insulation, the granular serves also for the evening out of unevenness and height differences of the underground.
- **PE-Foils:** construction foils and individual configurable packing foils in exigent quality.
- **VIP- Insulating materials**

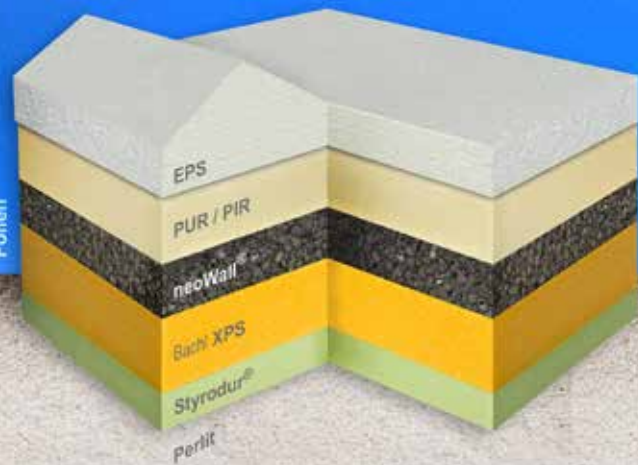

The information in this publication are based on our current knowledge and experience. A guarantee of certain properties or the suitability of the product for a specific purpose cannot be derived from our data. All descriptions, drawings, photographs, data, proportions, weight, etc. contained in this publication may change without notification and do not represent the contractually agreed quality of the product. Subject to technical changes, dimensional changes, printing errors and mistakes. As from November 2017.

**Karl Bachl Kunststoffverarbeitung GmbH & Co. KG**

Deching 3 | 94133 Röhrnbach | Tel. +49 8582 809-350 | daemmstoffe@bachl.de  
[www.bachl.de](http://www.bachl.de)



Create values together.

special  
 $\lambda$ -value 0.007 W/(mK)

## VACUBOARD

The high-quality high-efficiency thermal insulation slab:

with thinner structure height | for redevelopment and new buildings  
 with extremely good thermal conductivity by all slab strengths | for an individual installation plan

## VARIOUS APPLICATION USES

From cellar to roof

Insulation of flat roof, balcony and terrace

Interior insulation (floor, wall)

Insulation of cooling and cold components

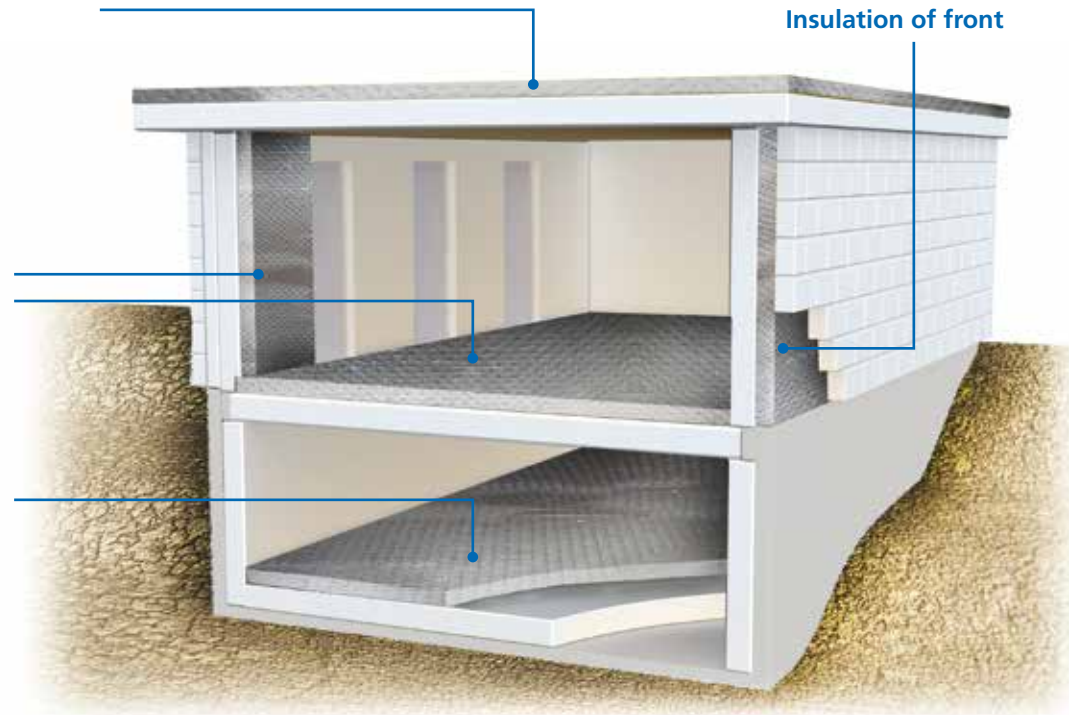

High-performance insulation made from pressed, pyrogenic orthosilicic acid that is enveloped in an airtight, multi-layered wrapping film in a vacuum setup and then laminated on both sides with a 3-mm-thick rubber granulate plate.

The slender plate thus becomes the ideal problem-solver wherever there is a shortage of space but good thermal insulation is needed. Production takes place on the basis of precise determination of the area and creation of an installation plan that takes into consideration the required standard and special plate formats. In addition to the technical advice, Bachl also offers you comprehensive service in planning and execution of construction work.

Please also note the supply of accompanying processing and product information.



Installation of the Vacuboard for balcony constructions

Properties			
Type of quality	Vacuum insulation		
Application	DAA, DEO, WAB		
Core	Pyrogenic silica powder		
Foil	cComposite foil (aluminium-metallized)		
Size range	1300 x 600 / 1200 x 600 mm		
	1000 x 600 / 1000 x 350 / 1000 x 300 / 1000 x 275 mm		
	1000 x 250 / 1000 x 200 / 600 x 500 / 600 x 800 / 600 x 600 mm		
	600 x 400 / 600 x 350 / 600 x 300 / 600 x 275 / 600 x 250 mm		
	600 x 200 / 400 x 300 / 300 x 250 mm		
Slab thickness	20 - 40 mm		
Edge formation	dull		
Technical Data			
Thermal conductivity $\lambda$ , rated value (d)	0.007 W/(mK)		
Sd-value m	> 1000		
Compression strength $\sigma_{10\%}$ (DIN EN 826)	ca. 140 - 180 kPa		
Bulk density	180 - 220 kg/m <sup>3</sup>		
Temperature resistance	(-50°C bis +90°C)		
Fire reaction (DIN EN 13501-1)	RtF-E		
Reaction	Chemically and biologically neutral; FCKW-, HFCKW- und HFKW-free		
Disposal	Waste code number 170604 according to the European waste catalogue (EAK) valid for segregated material, material and thermal recycling possible		
Thickness [mm]	20	30	40
R-Value 0.007 [m <sup>2</sup> K/W] (D)	2.857	4.286	5.714

## INSTALLATION EXAMPLES

for different applications

### Roof structure with Vacuboard insulation

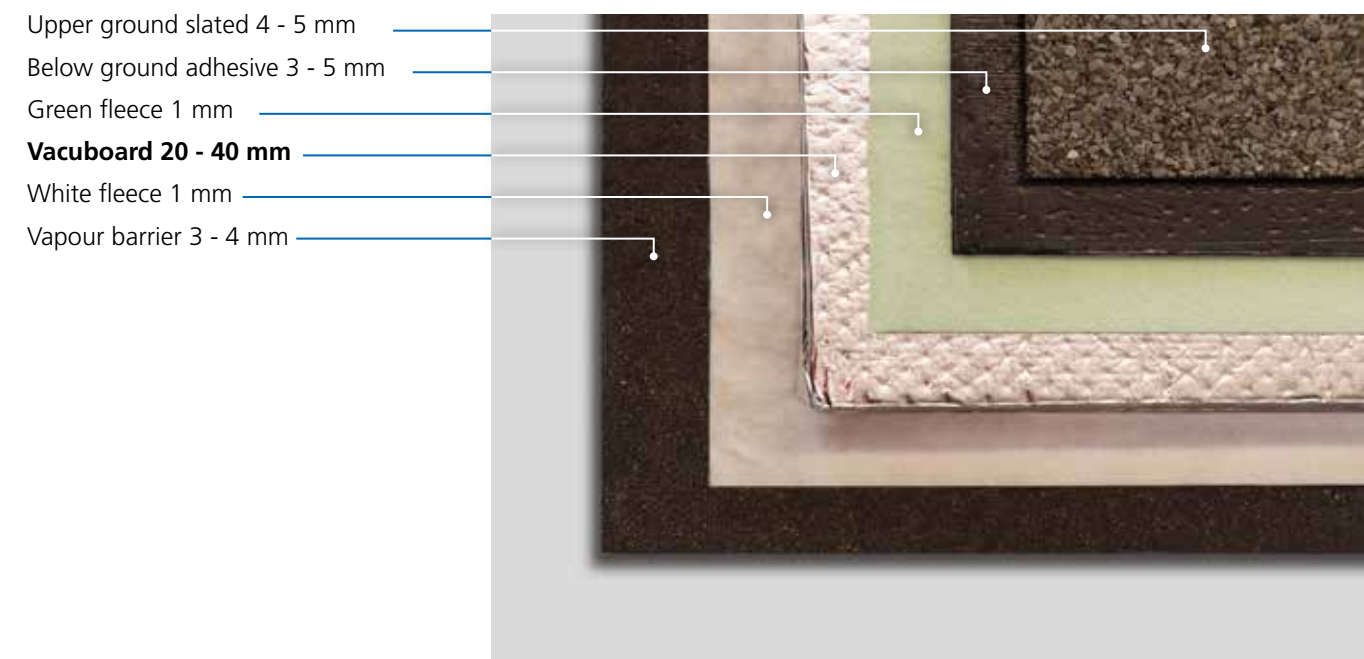

### Flat-, terraces and balcony construction with the Vacuboard insulation

